

MAG-POWER[®]

PLASMA Cutting Systems

Industrial Grade Plasma Cutting Machines & Accessories



- Portable High Performance Cutting System
- Rugged Epoxy-Coated Steel "Toolbox" Cabinet
- Industrial Steel Core Transformer Power Supply
- Heavy-Duty Cutting Torch with Extended Life Tip
- Manufactured in the U.S.A.

MAG-POWER®

PLASMA Cutting Systems

Industrial Grade Plasma Cutting Machines & Accessories

FEATURES

- Sure firing pilot-arc ignition starts every time and maintains constant arc
- Industrial grade transformer provides smooth high current output
- Cooling fan circulation system sustains 60% duty-cycle cutting
- Automatic reset thermal overload provides optimum machine protection
- Heavy-duty work clamp attaches easily to oversized material
- Operator adjustable cutting depth with air regulator and pressure gauge
- Low voltage machine/torch interlock circuit ensures operator safety
- Generator compatible for field application and maintenance operations

PERFORMANCE

Plasma Cutting Speeds

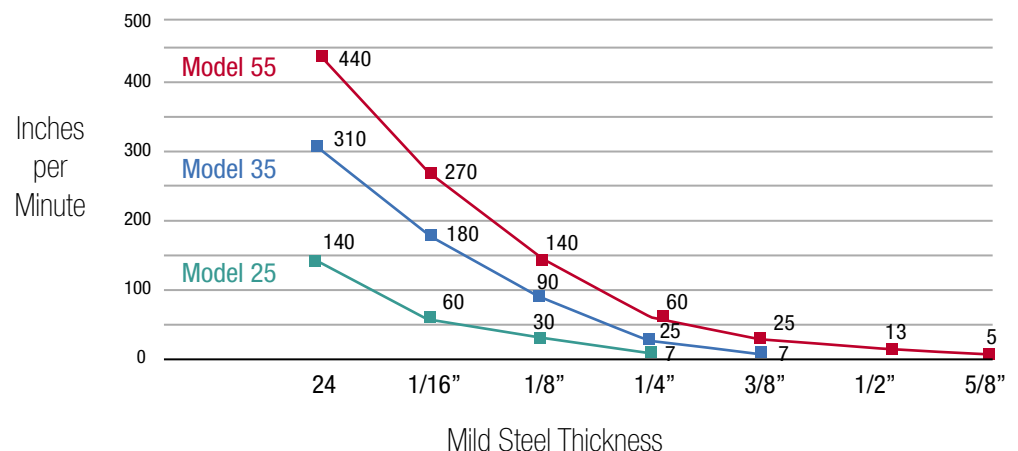

SPECIFICATIONS

MODEL 25

3/16" Genuine Cut

Produces a full 18 amps of output power that sever cuts 1/4" mild steel. Package includes machine with 3-prong NEMA 5-15 UL power cord, compact cutting torch & heavy-duty work clamp with 12 ft. cable assemblies, spare cutting tips, spare electrodes and complete operator's manual.

Input Power: 120 VAC @ 60Hz	Output Voltage: 94 VDC
Input Current: 20 Amps	Output Current: 18 Amps
O.C. Voltage: 280 VAC	Duty-Cycle: 60% @ 40 C
Air Pressure: 3.5 scfm (95 l/min)	Air Supply: 70 psi (4.8 bar)
Dimensions: 6.25"W x 16"D x 11"H	Weight: 44 lbs. (20 Kgs)

MODEL 35

5/16" Genuine Cut

Produces a full 28 amps of output power that sever cuts 3/8" mild steel. Package includes machine with 3-prong NEMA 6-15 UL power cord, compact cutting torch & heavy-duty work clamp with 12 ft. cable assemblies, spare cutting tips, spare electrodes and complete operator's manual.

Input Power: 230 VAC @ 60Hz	Output Voltage: 94 VDC
Input Current: 15 Amps	Output Current: 28 Amps
O.C. Voltage: 280 VAC	Duty-Cycle: 60% @ 40 C
Air Pressure: 3.5 scfm (95 l/min)	Air Supply: 70 psi (4.8 bar)
Dimensions: 6.25"W x 16"D x 11"H	Weight: 44 lbs. (20 Kgs)

MODEL 55

1/2" Genuine Cut

Produces a full 40 amps of output power that sever cuts 5/8" mild steel. Package includes heavy-duty machine with #10-3AWG UL power cord, compact cutting torch & heavy-duty work clamp with 20 ft. cable assembly, heavy-duty work clamp & cable, spare cutting tips, spare electrodes and complete operator's manual.

Input Power: 240 VAC @ 60Hz (max.)	Output Voltage: 105 VDC
Input Current: 32 Amps (max.)	Output Current: 40 Amps (max.)
O.C. Voltage: 280 VAC	Duty-Cycle: 60% @ 40 C
Air Pressure: 4.25 scfm (115 l/min)	Air Supply: 70 psi (4.8 bar)
Dimensions: 10"W x 18.5"D x 14"H	Weight: 98 lbs. (44.5 Kgs)



MAG-POWER®

PLASMA Cutting Systems

Industrial Grade Plasma Cutting Machines & Accessories

Toll-Free Tech Support
1-800-554-0074

www.mag-powerequip.com

ACCESSORIES

NT2060 Plasma Torch

Item	Part #	Description
1	907N7925	NT2060 Plasma Torch Head 70d
2	907N5601	Electrode Standard
3	907N7928	Start Cartridge
4	907N6060	Swirl Ring / Gas Distributor
5	907N5470	Cutting Tip 30A .030 (.75mm)
5A	907N5471	Cutting Tip 40A .035 (.90mm)
6	907N6480	Shield Cup, Standard

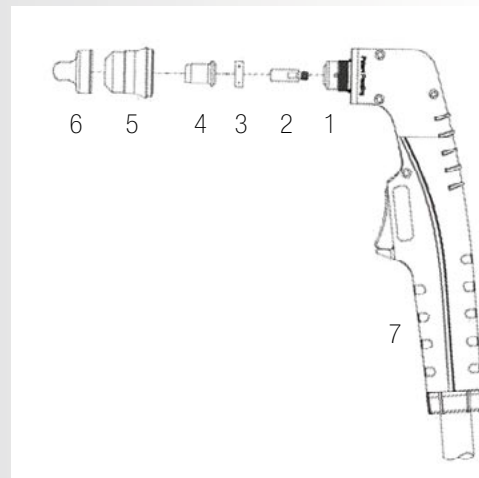

Circle Cutting Kit

Fitted torch carriage, magnetic, diamond-point & center-drill pivot posts and 10" & 16" radius arms with wrench in compact carrying case.



Air Filter/Dryer

This disposable air filter/dryer attaches directly to the machine input fitting to keep damaging contaminants and moisture away from the plasma torch.



Plasma Machine Cart

Heavy-duty cart easily moves machine around the shop and provides convenient storage for accessories, air hoses safety glasses & gloves.



Extension Power Cord & Air Hose

These 25' and 50' extensions are designed specifically to meet the requirements of your portable plasma cutting system to ensure optimum performance in the field.